



Middle Years Handbook

CONTENTS

CONTENTS

Executive Principal's Welcome	4
Middle School Leadership Team	5
Benalla P-12 Overview	6
College Vision	6
Overview	6
Curriculum.....	6
Literacy and Numeracy	6
Student Leadership group (SLG).....	7
House System.....	7
Music	7
Year 7.....	7
Year 8.....	8
Year 9.....	8
Careers Program.....	8
School For Student Leadership – Alpine School	9
School Wide Positive Behaviour Support.....	9
Student Behavioural Expectations	9
Classroom Management Processes	10
Students with Disabilities and Additional Needs	11
Camps and Excursions.....	12
Camps, Sports & Excursion Funding (CSEF).....	12
Student Wellbeing and Welfare	12
What Is Wellbeing?	13
Breakfast Program	13
Respectful Relationship Program	14
Doctors In Secondary Schools Program.....	14
Compass Parent And Student Portal	15
Accessing Compass.....	15
General Information.....	15
School Uniform	15
Bell Times	16
Parent Involvement	16
School Council	16
Procedures For Absences From School.....	17
Medication.....	17
Diaries.....	17
Out of School Hours Care	17

Fees and Charges.....	17
Newsletter.....	18
Facebook & Instagram.....	18
Website.....	18
Canteen	18
Faithfull St Campus Map	19



Benalla P-12 College

Executive Principal – Kylie Cotter

EXECUTIVE PRINCIPAL'S WELCOME

Dear Students and Families,

Welcome to Benalla P-12 College's Middle Years - 7 to 9. Our focus in this stage of learning is to add depth and breadth to each student's learning in all curriculum areas, and to ensure they are fully prepared for the senior stage whether they choose VCE or VCE VM.

This handbook will provide you with information about our specifically designed programs for each Year level.

At Benalla P-12 College we aim to develop in our students a love of learning, strong communication skills, the ability to be responsible, creative and critical thinkers and to be socially connected and resilient. We also aim to ensure all students are well prepared for the workforce with essential literacy and numeracy skills and a good understanding of what it means to be employable.

Year 7 and 8 students have the opportunity to try different subjects from the Arts and Technology areas. They also continue with essential literacy and numeracy lessons across the week and experience specialist teaching in our outstanding Science wing.

Year 9 is a unique year where students begin the journey to develop a career pathway, as well as having a range of challenging activities as part of their program. Vocational assessments are completed, Career Action Plans are developed and there are Mock Interviews to put skills into practice. Selected students can opt to take part in the School for Student Leadership at one of the four campuses across the state.

We believe that all students need care and support as they grow and they will be better prepared for learning if they are happy, safe and healthy.

Our primary goal is to provide an excellent education for every child in every classroom.

Our highly dedicated and professional team of teachers work tirelessly to ensure that the school motto of "Committed to Excellence" is brought to life on a daily basis in all classrooms.

We value education as a partnership of children, staff, parents and the local community. I look forward to our partnership, and am truly excited with the directions, possibilities and opportunities for education at Benalla P-12 College.

Yours Sincerely

Kylie Cotter

Executive Principal



MIDDLE SCHOOL LEADERSHIP TEAM

ASSISTANT PRINCIPAL

MRS KARLIE MCGRATH



My role as Assistant Principal is one that is responsible to help to educate our students *for the future through a commitment to excellence in teaching, high expectations and positive relationships in a safe and inclusive environment. This is in line with our College Values.*

I am responsible for a variety of areas that assist in the development of positive relationships to enhance student engagement and accountability.

Working with Sub School Leaders and Year Level Co-ordinators, we collaborate to ensure that high expectations around student behaviour and learning are aligned to the College's vision and values and are documented in policies and guidelines. We have documented processes to allow students to understand that there is a consequence for failing to adhere to our values. Our sub school teams meet regularly to review processes and ensure that consistency is maintained.

I am part of the School Wide Positive Behaviour Support Team, which implements strategies to elicit appropriate behaviour amongst our students. We also create reward systems to acknowledge the expected behaviour that we require from our students.

My interactions with our wellbeing staff enable us to commit to our Respectful Relationships program to help students practice respect for themselves and others.

SUB SCHOOL LEADER (YEARS 7-9)

Ms JOHANNA ADAMS



My role as a Sub School Leader is to lead a team of Year Level Coordinators that support a positive and respectful learning environment. Our team implements a range of policies and procedures to ensure that the orderly learning environment occurs and that all students are in a supportive environment. We also implement a range of different programs that focus on the social and emotional well-being of our students that foster positive and respectful relationships within our school community, this includes engagement and regular communication with all involved in the learning process.

Benalla P-12 College ensures that every child learns and is prepared for the future through a commitment to excellence in teaching, high expectations and positive relationships in a safe and inclusive environment.

OVERVIEW

We aim to provide a college community environment which is safe, caring and engaging for young people. We have set high standards for ourselves and expect the same of all our students, staff, volunteers, families and visitors to the school.

Students' time in the Middle Years (Years 7 to 9) is a time for learning new and exciting things, ensuring that core knowledge is established, making choices, forming positive relationships, taking healthy risks and learning lots about oneself.

Benalla P-12 College offers a wide range of studies and is a highly successful example of secondary education in the North Eastern Victoria Region.

Benalla P-12 College has three campuses:

Avon St Campus (Foundation – Year 4)

Waller St Campus (Foundation – Year 4)

Clarke St Campus (Years 5-6)

Faithfull St Campus (Years 7 - 12)

Years 7 to 9 is critical in establishing a solid grounding in the skills; knowledge and study habits which provide a basis from which students can succeed in and enjoy their entire secondary school life.

Our program is designed to meet the particular needs of our younger students and to provide a secure learning environment in which students are valued.

CURRICULUM

The Benalla P-12 College curriculum is based on the principles of access and success for all students. The Years 7-9 curriculum is based on the Victorian Curriculum in line with the rest of Australia. The curriculum for Years 11 and 12 is based on the Victorian Certificate of Education (VCE), Victorian Certificate of Education - Vocational Major (VCE-VM), and Vocational Education and Training (VET). Benalla P-12 College offers a wide range of courses allowing students to pursue many careers and be strong civic contributors. We have won state-wide awards in the Victorian Education Excellence Awards for our work in supporting excellent student pathways.

Benalla P-12 College places strong emphasis on participation in extra-curricular activities such as camps, excursions, sporting activities, language academy, drama, music, hands-on learning opportunities and work experience and emerging academies like the Language and Technology academies.

Students in Years 7 to 9 undertake a program that gives them access to all key learning areas. Each learning area offers diverse programs and a range of learning activities to deliver the learning outcomes identified in the Victorian Curriculum.

LITERACY AND NUMERACY

Benalla P-12 College provides a strong emphasis on Literacy & Numeracy. This has included: extensive teacher professional development, team teaching, the testing and interviewing of students to determine their individual needs and personalised learning programs for students.

STUDENT LEADERSHIP GROUP (SLG)

Student voice is highly valued at Benalla P-12 College. Our student leaders are the College School Captains, Vice Captains and elected student leadership groups in years 7-9. Our Student Leadership Group (SLG) members represent students in our school and organise ways for students to participate in and contribute to our school community. They work democratically to represent the student body in school decision-making. Other student leadership bodies include the Indigenous "Us Mob" group and student committees formed to host special events or raise funds for specific community causes or events.

HOUSE SYSTEM

Aligning with Benalla P-12 College school values, the House System aims to develop the whole student. Our house system aims to increase participation and school pride at school events, motivate students to focus on learning and increase school community engagement and participation resulting in stronger learning outcomes for students.

Benalla P-12 College has four houses. Students are able to win house points at school sports, activity afternoons or by showing behaviours which reflect our school's values. Each student belongs to one of the following houses:

Stirling 

Buller 

Hotham 

Buffalo 

MUSIC

Music at Benalla P-12 College is offered through both classroom Music (Prep- Year 8) and Instrumental Music (Years 7-12). Instrumental Music provides the students the opportunity to receive small group tuition on Woodwind, Brass, or Percussion instrument. Students learn an instrument from one of the Instrumental Music teachers at the College.

Specialist tuition on any of these instruments is free.

The Music Department has an extensive band program featuring the following groups:

- Year 7 Band
- Year 8 Concert Band
- Symphonic Band
- Stage Band
- Small groups and ensembles

These groups have regular school rehearsals before, during, and after-school, and perform publicly as often as possible. Students learning an instrument at the College will rehearse and perform in at least one of these ensembles. Students will have the opportunity to participate in music camps and festivals.

Classroom Music aims to further extend the musical knowledge and ability of each student. The course looks at 5 main areas:

- Performance Skills – guitar, drums, keyboard, bass guitar, singing
- Creative Skills/Composition
- Aural Training/Listening Skills
- Theoretical Skills
- Music Technology – computer software

YEAR 7

The Year 7 program is focused on creating an experience that will provide the students with the following advantages:

- Easy transition from Year 6 to Year 7
- The opportunity to further develop relationships integral to learning
- Increased student engagement in learning
- Development of critical thinking skills.

Year 7 students experience studies in eight Learning Areas; these include core subjects Maths ,English, Science, Humanities, Indonesian, Music, Health & Physical Education. All core subjects operate throughout the year. Non Core subjects include: Art, Digital Technologies, Food & Technology. These non-core subjects run for one semester.

YEAR 8

Students experience six core Learning Areas that run the entire year. These include: Maths, English, Science, Humanities, Health and PE, Indonesian & Music. Across the year each form will have Art & Digital Technology, Food Tech and Technology.

The variety of subjects enables students to have a broad range of experience across all Learning Areas before choosing further electives for Year 9.

The Year 8 students participate in 3 x 75 minute education sessions of teen Mental Health First Aid delivered by Mental Health First Aid accredited trainers. Live4Life was created in response to a reported increase from schools and agencies, in regards to a rise in depression, anxiety, cyber bullying and self-harm which has led to the need for a coordinated response to address our young people's mental health.



YEAR 9

Students experience five core Learning Areas that run the entire year. These include: Maths, English, Science, Humanities, Health and PE. The Year 9 are also eligible to choose their own electives. The electives include subjects such as: Digital Technology, Auto, Outdoor Education, Peak Performance, Metal, Art, Jewellery, Food and Music Performance. These provide students with the opportunity to work in a range of theory and skills, individually and as part of small groups. Students select an area of focus to work towards and present for assessment. Most of the Year 9 classes are based in the Year 9 Centre. This year, the Year 9 has a Floating Period which runs once a week with assigned Floating teachers. The Floating Period is used for assemblies, mentoring class, daily notices and other extracurricular activities.

CAREERS PROGRAM

Benalla P12 College delivers an intensive, personalised Careers Program for all Year 9 students designed to improve student aspirations for successful Year 12 completion and beyond. Students develop an 'Achievement Portfolio' which includes a Career Action Plan, employability skills, audit, and evidence of their achievement. Students undertake mock job interviews which involve all elements of the job application process, including selection of appropriate clothing. This work, together with a record of activities, is then presented to a family member during Year 10 course selection. The portfolios are stored in the Careers room and are designed to be revisited over the next year 3 years.

SCHOOL FOR STUDENT LEADERSHIP – ALPINE SCHOOL

The School for Student Leadership is a Victorian Department of Education and Training initiative offering a unique residential education experience for Year 9 students. This program will be confirmed by the end of Term 3.

The curriculum focuses on personal development and team learning projects.

The School for Student Leadership (SSL), previously known as an Alpine School operates on three campuses:

1. Alpine school campus, Dinner Plain
2. Snowy River campus, Marlo
3. Gnurad – Gundidj campus, Glenormiston

A team of four to six students are chosen via application and attend the school for a term. While at the school they continue their education in an inclusive setting and participate in a wide range of outdoor activities to strengthen both their teamwork and leadership skills. The students also begin a community learning project which is completed when they return to their home school.

All students who have attended the school for student leadership have found it to be a positive, life experience.

Past students who have attended the Alpine School have found that they learnt many valuable skills including self-awareness, social awareness, metacognition, culture diversity, decision making and more. They also experienced fun, new outdoor activities like surfing and caving. Students have found that the skills they have acquired during this program have added to their life long skills that can be transferred at home and school.

SCHOOL WIDE POSITIVE BEHAVIOUR SUPPORT

Benalla P-12 College is a Positive Behaviour Support School. Positive Behaviour Support is a framework that concentrates on teaching explicitly the behaviours we expect of students and then rewarding students when they demonstrate these desired behaviours.

Our expected behaviours at Benalla P 12 College are based on our four values:

Respect, Responsibility, Integrity and High Expectations

We have developed matrixes of expected behaviours for the school in relation to these values. These behaviours are for both staff and students. Rewards for students demonstrating the correct behaviours include verbal praise; positive postcards mailed home and raffle tickets. These raffle tickets are drawn during assemblies and students receive various prizes. Each raffle ticket also gains the student a house point.

As part of the Positive Behaviour Program data is collected on all behavioural issues. This data is used to ensure we are targeting our explicit teaching of required behaviours in the appropriate areas of need.

Overall Positive Behaviour Support is about:

- Establishing and teaching clear expectations for all students in all settings.
- Establishing and teaching clear expectations for all staff.
- Modelling and rewarding these expectations.
- Helping schools, staff, families and community members understand and support the diversity of students, including those students with the most intense support needs.
- Understanding the physical and social contexts of behaviour.
- Using data to guide decisions regarding change.

The School Wide Positive Behaviour Framework helps create a positive school culture where the emphasis is on rewarding the correct behaviour rather than punitive measures for students not demonstrating our school values.

STUDENT BEHAVIOURAL EXPECTATIONS

Benalla P-12 College is committed to providing a safe, secure and stimulating learning environment for all students.

We understand that students reach their full potential only when they are happy, healthy and safe, and that a positive school culture helps to engage students and support them in their learning. Our school acknowledges that student wellbeing and student learning outcomes are closely linked.

Behavioural expectations of students, staff and families are grounded in our school's Statement of Values. We are guided, therefore, by our student engagement and wellbeing policy.

The objective of this policy is to support our school to create and maintain a safe, supportive and inclusive school environment consistent with our school's values.

Benalla P-12 will institute a staged response, consistent with the Department's Student Engagement and Inclusion Guidelines. Where appropriate, parents will be informed about the inappropriate behaviour and the disciplinary action taken by teachers and other school staff. Disciplinary measures may be used as part of a staged response to inappropriate behaviour in combination with other engagement and support strategies to ensure that factors that may have contributed to the student's behaviour are identified and addressed.

Disciplinary measures at our school will be applied fairly and consistently.

Students will always be provided with an opportunity to be heard.



CLASSROOM MANAGEMENT PROCESSES

Teachers are required to follow a classroom management plan, to try to engage students in their learning. To keep classes running without disruption, the college created the **4 step process**: **This process is based on a reminder/warning system.**

- First warning to alert the students of the unacceptable behaviour.
- Second warning; Student is asked to move to another part of the room or area next to room.
- Third warning is to understand that an exit from class is imminent and a consequence of detention/reflection will follow.
- If behaviour continues or is dangerous the student is removed from class.

Upon an Exit

- Teacher must contact the exit teacher or general office by phone (preferable) or send another student to inform them a student has been exited (if required).

- Student exited by a designated exit teacher to another class room or to a buddy teacher with a behaviour reflection sheet to complete. The student



is made to realise that an automatic lunchtime reflection is imminent.

- Student remains in the exit until the end of the lesson.
 - If a student refuses to exit they will at minimum receive an After School Reflection. In some cases, they will be sent home and/or suspended for their defiance.
 - The teacher writes a report of the incident on compass, informs the Year Level Coordinator and arranges the lunchtime reflection. The teacher organises and completes a restorative conference, to discuss the behaviour and the completed behaviour reflection sheet. (The purpose of this conversation is to restore the relationship and focus on the behaviour). The restorative may be held with the sub-school leader, the year level coordinator, or another staff member.
 - If the student is refusing to attend a reflection, the Year Level Co-ordinator is available to assist. The teacher and/or The Year Level Co-ordinator is required to contact parents and discuss the incident after the designated reflection. Another reflection is to be arranged by both parties.
 - Repeated removal from class requires a parent meeting and the formation of a student support group. Continued removal from class or other transgression may result in suspension. This may be either 'in school' or external. One-off cases e.g. physical violence, theft or drug abuse may also lead to suspension. All suspensions will require a parent meeting to review the student's behaviour management plan.
- *Suspension procedures must follow the Education and Training Reform Act 2006, Ministerial Order 6.
*Continued high level behaviour issues may result in the commencement of expulsion proceedings
*Expulsion procedures will accurately follow all Departmental guidelines.

STUDENTS WITH DISABILITIES AND ADDITIONAL NEEDS

Benalla P-12 College is committed to inclusive practices that support all children and young people, including those with disabilities and special needs. Every child deserves a great education to reach their full potential, and our passionate, dedicated and experienced staff are committed to providing a safe, secure, supportive and engaging environment for students with various disabilities across all year levels.

Student Support Groups meet regularly to determine programs and resources to support each students' individual needs and to develop Individual Learning Plans. The College has a number of Education Support staff, the Student Inclusion Coordinator and Wellbeing staff to support these students and offer a range of programs such as speech therapy, life skills, fine motor activities and social skills to cater for individual needs. Speech and occupational therapists are also employed by the College to conduct assessments, to complete student observations, provide individual and small group therapy and advice to Student Support Groups.

Some students receive therapy from private providers under the NDIS and the school liaises with family and therapists to achieve the best outcomes for these students.

Staff complete professional learning opportunities to support our students with additional needs. A number of staff have completed additional study in the area of autism.

For further information regarding our PSD program or the individual needs of your child please contact your Campus Principal or the Student Inclusion Coordinator.

CAMPS AND EXCURSIONS

Benalla P-12 College believe that camps and excursions are an integral part of learning, therefore are an important part of the overall college program. These experiences provide students with social and educational experiences not available in a conventional classroom. Students develop essential personal and social skills such as communication, resilience, self-confidence, leadership and teamwork.

We believe that all students should participate in camps and excursions. Benalla P-12 College can assist some students with financial difficulties.

If you need financial assistance for a trip, please do not hesitate to contact our wellbeing team member or Business Manager.

CAMPS, SPORTS & EXCURSION FUNDING (CSEF)

School **camp**s provide children with inspiring experiences in the great outdoors, **excursions** encourage a deeper understanding of how the world works and **sports** teach teamwork, discipline and leadership. All are part of a healthy curriculum.

The Camps, Sports and Excursions Fund (CSEF) provides payments for eligible students to attend activities like:

- school camps or trips
- swimming and school-organised sport programs
- outdoor education programs
- excursions and incursions.

If you hold a valid means-tested concession card or are a temporary foster parent, you may be eligible for CSEF. The fund will be paid to the school to use towards expenses relating to camps, excursions, or sporting activities for the benefit of your child.

The annual CSEF amount per student will be: \$125 for primary school students and \$225 for secondary school students.

Contact the school office to obtain a CSEF application form or download from www.education.vic.gov.au/csef

RESPECTFUL RELATIONSHIP PROGRAM

As part of the Wellbeing program students have lessons in the Respectful Relationship Program. The Resilience, Rights and Respectful Relationships learning materials have been designed for teachers in primary and secondary schools to develop students' social, emotional and positive relationship skills. Efforts to promote social and emotional skills and positive gender norms in children and young people has been shown to improve health related outcomes and subjective wellbeing. It also reduces antisocial behaviours, including engagement in gender related violence.

DOCTORS IN SECONDARY SCHOOLS PROGRAM

Benalla P-12 College is part of the Doctors in Secondary Schools Program, which means an adolescent-trained GP (General Practitioner) Dr Fleur Christopheson from Benalla Church Street Surgery and Dr Ben Weatherhead from the Coster Street Medical Practice will be operating on school grounds each Tuesday from 9:00am to 12:30pm to provide free access to primary health care for secondary students at our school. Every second week, Dr Fleur Christopheson will attend from 9:00 am to 2:45pm.

As part of the Doctors in Schools program, students also have the opportunity to make an appointment with visiting Nurse, Shellie Davis. Students can make appointments directly with Shellie every Tuesday at the School's Dr Surgery.

Appointments can be scheduled by phone call or text message on **0427752398**.

Alternatively, you can contact the Wellbeing team on 5761 2777 who will arrange a suitable time.



Students and Parents of Benalla P-12 College have an electronic portal where they are able to access all elements of a student's college life. This important tool will allow all parents and guardians to increase engagement with the school by allowing full access to your child's day to day activities.

The Parent Portal allows you to:

- Access a daily News Feed
- Provide online consent and payment for excursions and incursions
- Report absences
- View the School Calendar
- Access school documents and notes sent home
- Update email address and mobile number
- View Semester Reports
- View 'Learning Task' feedback
- Book Parent/Teacher Conferences
- Monitor Attendance

Please be assured that Compass uses technology that is encrypted and secure.

ACCESSING COMPASS

Compass is accessible on any modern web browser (Internet Explorer, Firefox, Chrome, Safari) via a desktop computer or mobile device. iOS and Android apps are also available (search for Compass School Manager in the App Store). Some of the features of Compass are only available in the 'browser' version e.g. booking interviews, viewing the School Calendar by week/month, accessing 'School Documentation' and Learning Task Rubrics. If however you tap on the menu icon in the app, there is an option to 'Open in Browser'.

To access Compass via your web browser on a desktop computer or mobile device:

Go to <https://benallap12-vic.compass.education> (link available on the www.benallap12.vic.edu.au for website)

To access Compass via the App:

Download the 'Compass School Manager' app and follow the prompts.

GENERAL INFORMATION

SCHOOL UNIFORM

School Uniform is compulsory and an important part of making students feel part of our school community. It instils pride and gives students a sense of belonging.

Uniform can be ordered from Judd's Yarrawonga on **57441269** or on designated days when the uniform shop is open in the Administration Wing of the Faithfull St campus.

*Please refer to Compass for future dates, and to view our School Uniform Policy. You can also check with the office staff if you would like a copy of our policy or need assistance with the ordering of uniform.

PE Uniform

In Year 7-12 is compulsory

It consists of a College sports shirt and navy sport shorts, sports shoes & school hat for outdoor activities.

School Hat

Our school has a Sun Smart Policy and children are required to wear a wide brimmed hat during 1st and 4th terms.

Please remember to name all items.

Lost Property

A designated lost property area is available for families to check for their property on each campus. Please ask office staff or classroom teachers for assistance with locating this area. It is the students responsibility to label their items clearly.

BELL TIMES

Monday- Friday	
Period	Time
Homegroup	9.00am to 9.06am
Period 1	9.06am to 10.06am
Period 2	10.06am to 11.06am
Recess	11.06am to 11.25am
Period 3	11.30am to 12.30pm
Period 4	12.30pm to 1.30pm
Lunch	1.30pm to 2.10pm
Period 5	2.15pm to 3.15pm

PARENT

Benalla P-12 partners in the encouraged a range of Club, School

INVOLVEMENT

College values the involvement of parents as development of student learning. Parents are to assist in school programs and to participate in formal and informal groups, including Parent Council and its sub-committees.

SCHOOL

The School Council is responsible for providing policy direction for the school. It is responsible for supporting the development of a Strategic Plan that provides the future direction for the school over a four year period.

COUNCIL

Elections are held yearly and if you are interested being part of school council, please advise the Principal.

PROCEDURES FOR ABSENCES FROM SCHOOL

Parents are asked to telephone the school before 8.30am on the morning of absence on 5761 2777 (Attendance Hotline) stating the student's name, year level and reason for absence. Alternatively, Please log into Compass and add an attendance note.

Parents/guardians will be contacted if a student is absent and we have not received notification of the absence. Unexplained absences will be investigated by our Administration staff.

Our School promotes “Every Day Counts” and It’s Not Okay To be Away.”

MEDICATION

If students require medication to be taken at school, it needs to adhere to our Medications policy. Teaching staff are not expected to administer medication to students.

If your child requires medication to be taken at school, it needs to adhere to our school policy. Our Medications Policy is available to view on our Website for all to view. <https://benallap12.vic.edu.au/schooldocuments/>

Please contact your child's Campus Principal to make arrangements.

DIARIES

Students from Years 7-12 are issued with a school diary that should be brought to school every day. It is expected that students take the diary to each class in order to record any information regarding homework or messages from teachers. This helps develop responsibility, organisational skills and good study habits.

OUT OF SCHOOL HOURS CARE

Before and After School Care and Vacation Care is available at the Avon and Waller Campuses.

Families are eligible to claim some level of Child Care Benefit – as a fee reduction.

For more information and bookings contact:

Avon St Office 5762 1646 Waller St Office 5762 2600

FEES AND CHARGES

Essential Student Learning Items

Essential student learning items are items, activities or services that are essential to support learning of the standard curriculum. These are items that the school considers essential for all students and which students take possession of.

Optional Items

Optional items are those items, activities or services that are offered in addition to or support instruction in the standard curriculum program. These are provided on a user-pays basis so that if parents choose to access them for students, they are required to pay for them.

Voluntary Financial Contributions

Parents can be invited to make a donation to the school for general or specific purpose, e.g. School grounds projects, library fund or for new equipment.

The essential student learning items costs will be advised to families during Term 4, and is payable in Term 1. Alternatively, booklists and fee information are available for viewing on the college website.

NEWSLETTER

Each week the college provides a newsletter for the school community, outlining important information and detailing events that have taken place. A notification is pushed out via our Compass App and published to the website. We encourage you to take the time to read the newsletter as a way of keeping up to date with news, upcoming events and announcements from staff.

FACEBOOK & INSTAGRAM

To stay up to date with School Events & Activities, follow us on  Instagram and Like us on Facebook. 

WEBSITE

Everything you need to know about the College is available on the website <https://benallap12.vic.edu.au/>. This includes information about specific campuses, bus travel, literacy & numeracy, newsletters, College policies and enrolment information.

CANTEEN

Students in Years 7- 12 can purchase food from the canteen at recess or lunchtime. Our Canteen is located just near the library and features a courtyard with picnic tables for students to enjoy! Parents, students and staff can place their order via the app by 9am each day and the order will be waiting for collection when the bell rings.

***Eftpos facilities are also available for students to use. (Students are not able to use their phones to use Eftpos at school)**

A canteen menu and instructions on how to download and use the QKR app are available on our website.

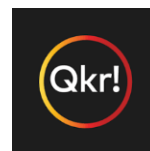

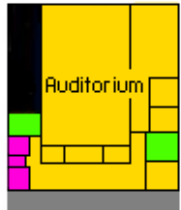

Performing Arts Centre

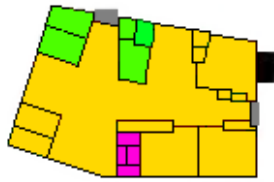

Year 9 Centre

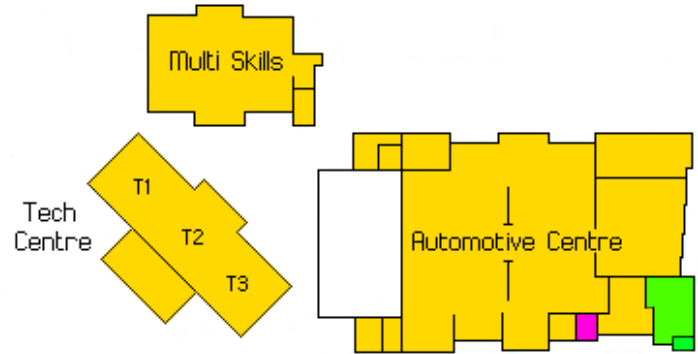

Tech Centre

Automotive Centre

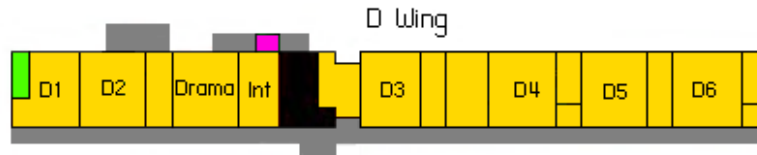

D Wing

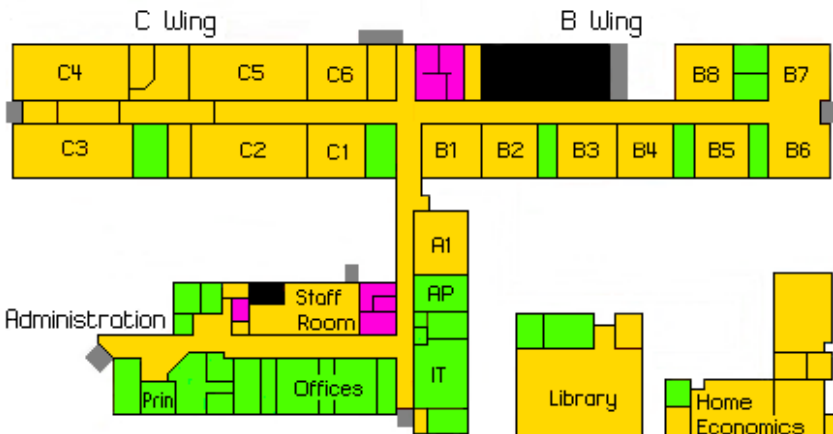

C Wing

B Wing

Administration

Library

Home Economics

Hairdressing

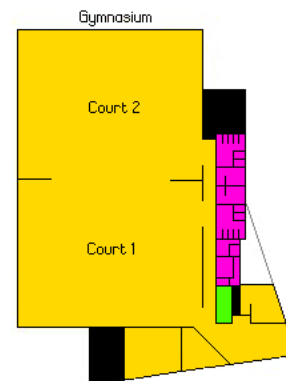
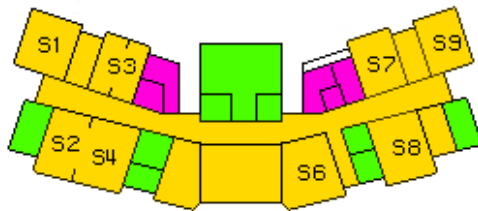

Gymnasium



Office

Staff

Art

